

# LT4 Gearheads

## Lifetime Series Harmonic Servo Gearheads

### Features

- Lifetime zero backlash
- Ultra-high repeatability (less than 10 arc-sec)
- High positional accuracy ( $\pm 1.5$  arc-min standard)
- NEMA 42, and metric
- Single stage, high reduction ratios from 50 to 200:1
- High output torque in a compact gearhead
- Low noise and heat generation
- High efficiency, torsional stiffness and torque-to-weight ratio

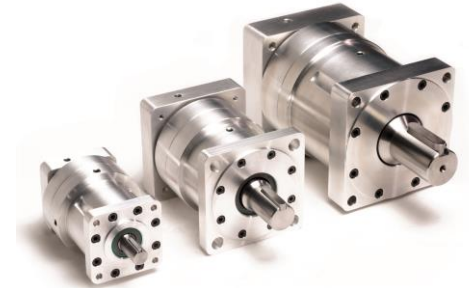

### Standard Specifications

Ratio		50	80	100	135	160	200
Nominal Output Torque <sup>1</sup>	Nm	100	100	120	120	120	120
Maximum Output Torque <sup>2</sup>	Nm	200	200	240	240	240	240
Nominal Input Speed <sup>3</sup>	rpm	3000					
Maximum Input Speed <sup>4</sup>	rpm	4800					
Max. Radial Load <sup>5</sup>	N	6012					
Max. Axial Load <sup>6</sup>	N	3985					
No-Load Starting Torque <sup>7</sup>	Ncm	38	18	16	14	12	11
No-Load Back Driving Torque <sup>8</sup>	Nm	11	14	15	20	21	22
Service Life <sup>9</sup>	hrs	25000					
Torsional Rigidity <sup>10</sup>	Nm/arc-min	32					
Repeatability	arc-sec	$\pm 10$					
Positional Accuracy	arc-sec	$\pm 90$					
Backlash	arc-sec	0					
Moment of Inertia	kgcm <sup>2</sup>	2.12					
Noise Level	dB(A)	< 67					
Protection Class	-	IP64					
Permitted Housing Temp.	°C	90					
Permitted Ambient Temp.	°C	0 - 40					
Lubrication <sup>11</sup>	-	Permanent					
Weight <sup>12</sup>	kg	6.3					

1) Rated torque at 3,000 rpm input for an average life of 25,000 hours

2) Exceeding the maximum output torque limit may immediately damage the drive

3) Input speed at rated output torque for an average life of 25,000 hours

4) The maximum intermittent input speed

5) At key center line, calculated at 100 rpm output speed and nominal output torque

6) At end of output shaft, calculated at 100 rpm output speed and nominal output

7) Minimum input torque required to turn the output shaft with no load

8) Minimum torque, if applied to the output shaft, that will cause the unit to back drive

9) Average life at nominal load and input speed

10) Torsional rigidity at nominal torque

11) Mobil Beacon 325 grease, synthetic oil available on request

12) Weight may vary slightly dependent upon adapter options

# LT 4 Dimensions

## NEMA 42

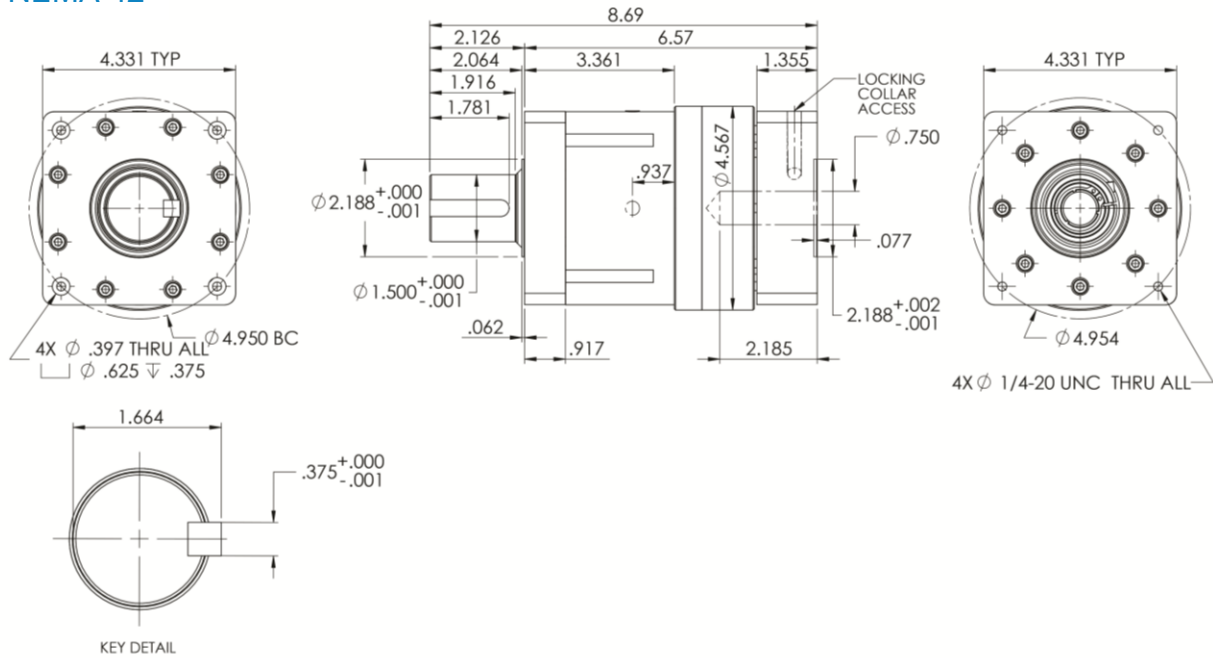

## Metric

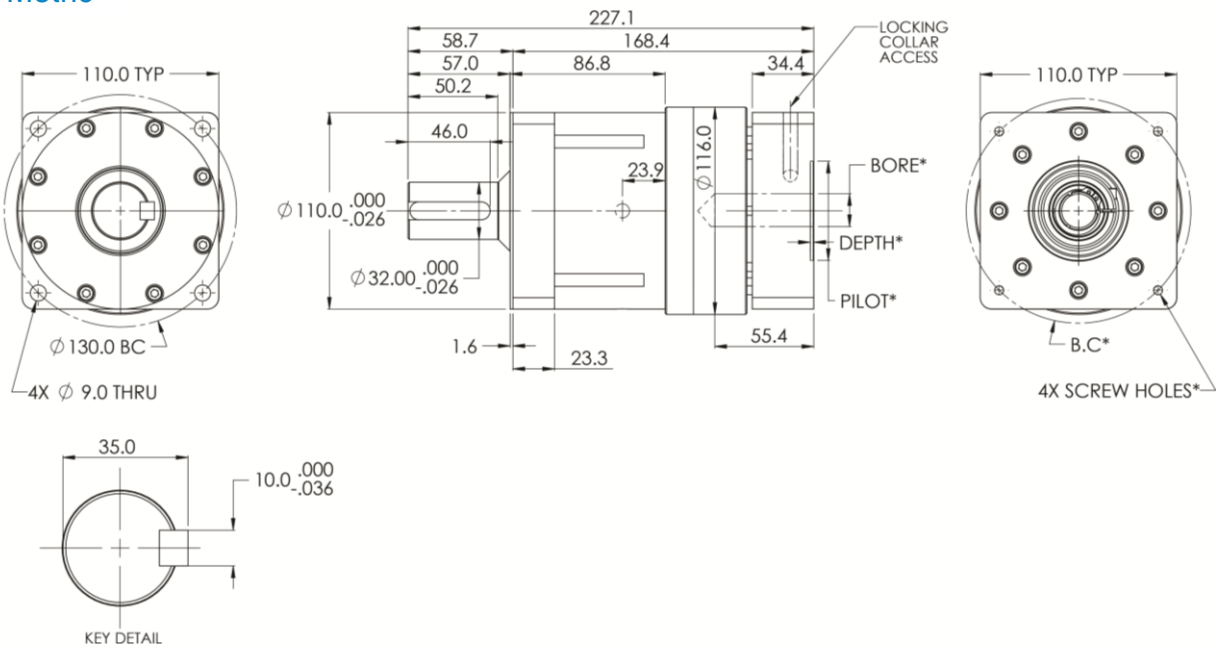

## Ordering Codes

