

(4) 5/16-18 X .47 FULL THREAD

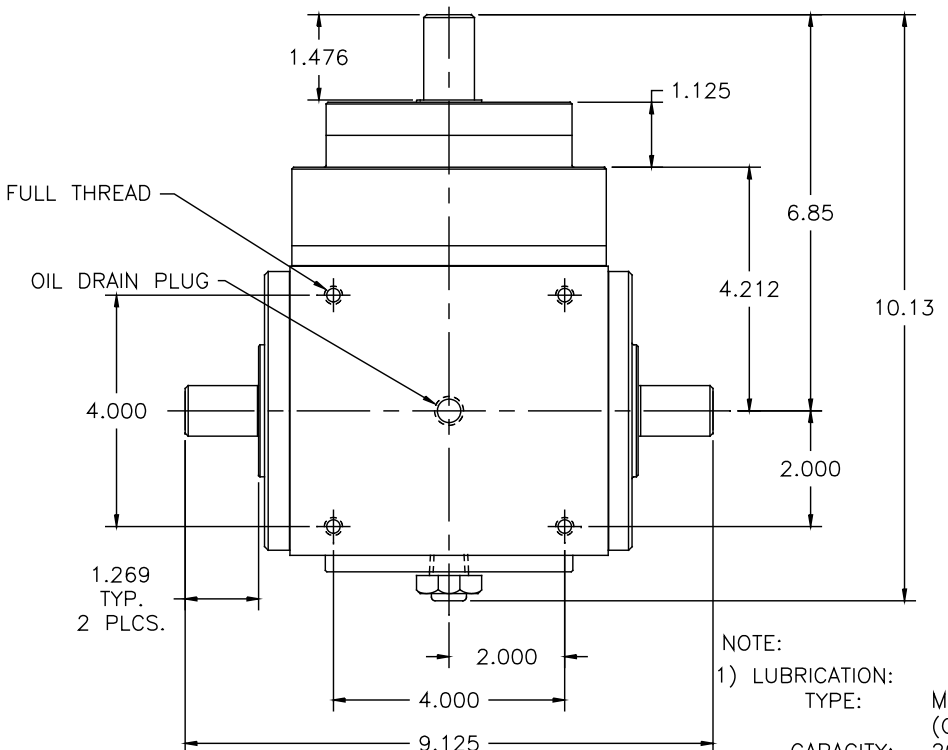

NOTE:
 1) LUBRICATION:
 TYPE: MOBILGEAR 627 (OR EQUIVALENT)
 CAPACITY: 20 oz.
 CHANGE FIRST @ 150 HR.
 INTERVAL: SUBS. @ 2000 HR.

2) OPERATING TEMPERATURE: 93°C MAX.
 3) WEIGHT: 50 lbs.
 4) S3 TO S2 RATIO: 80:1
 5) S1 TO S2 RATIOS: 1:1, 2:1
 6) RATED TORQUE @ THRU SHAFT SPEED:
 300 lb-in @ 2000 RPM
 371 lb-in @ 1750 RPM
 420 lb-in @ 1000 RPM
 MAX. E-STOP TORQUE = 1120 lb-in

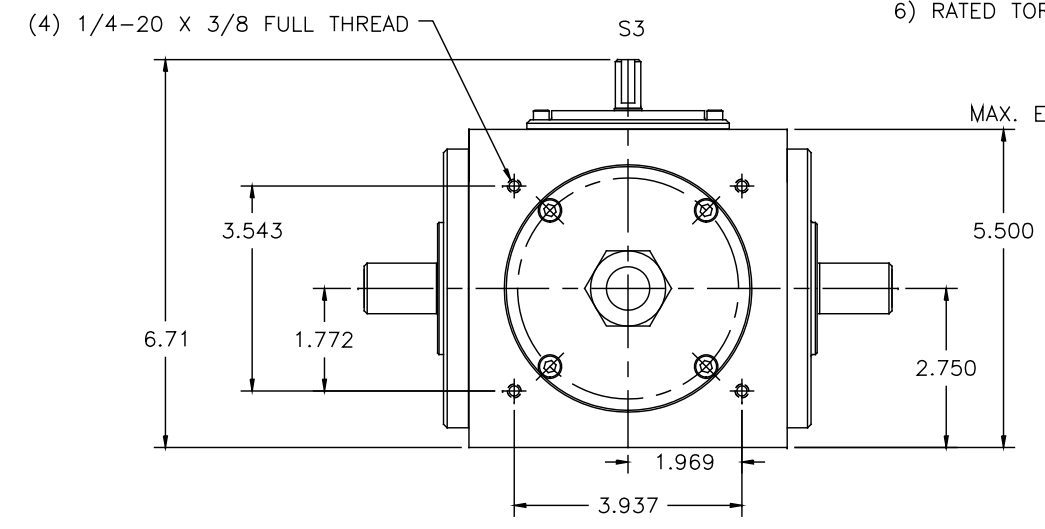
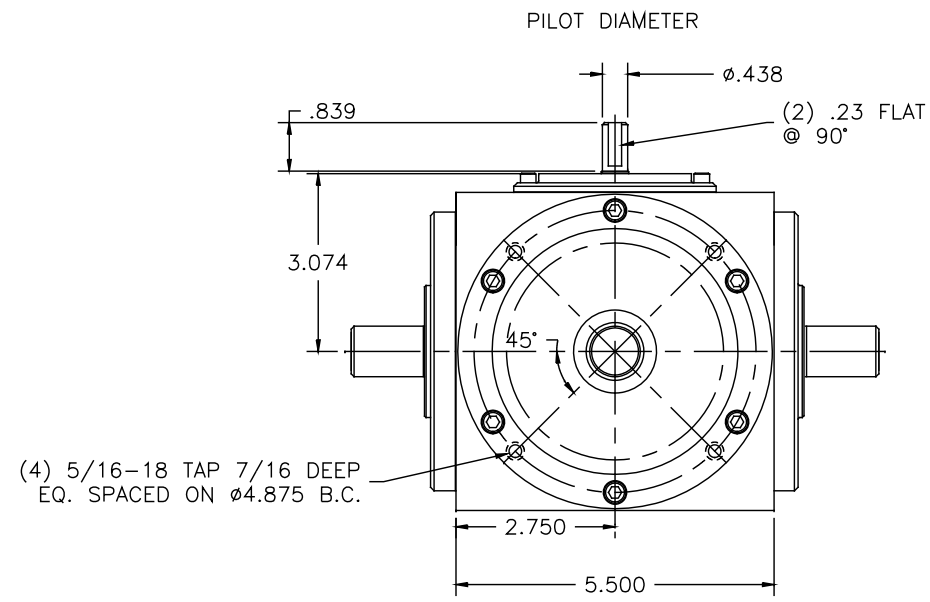

| RATIO | PINION | PART NUMBER |
|-------|--------|----------------|
| 1:1 | RIGHT | 300RD1:1S00RA1 |
| 2:1 | RIGHT | 300RD2:1S00RA1 |
| 1:1 | LEFT | 300RD1:1S00LA1 |
| 2:1 | LEFT | 300RD2:1S00LA1 |

FRONT VIEW

BACK VIEW

| SYM | DATE | CHANGE | CHNG | APPR |
|-----------|------|--------|------|------|
| REVISIONS | | | | |

| | | | | | |
|----------------------------|--|---|--------------------|----------------|--|
| UNLESS OTHERWISE SPECIFIED | | DO NOT SCALE DRAWING • BREAK ALL SHARP EDGES • | DRAWN BY: J ARENDT | DATE: 10/12/99 | CONIC SYSTEMS, INC HARMONIC DIFFERENTIALS & CONTROL SYSTEMS Eleven Rebel Lane, Port Jervis N.Y. 12771 |
| DIMENSIONS | | TOL. | MM | INCHES | |
| | | .X | ± | ±.030 | REPLACES: |
| | | .XX | ± | ±.010 | ASM/PART: 300-080R?S00?A |
| | | .XXX | ± | ±.005 | SIZE: SCALE: DWG: IM3C001-C |
| | | FRACTIONAL | | ±1/64 | REV: |
| | | ANGULAR | | ±1/2° | |
| | | THIRD ANGLE PROJECTION | | | |